



ROBBIE & LYNORE
ROBINSON
FINE ARTS
CENTER
STAGING THE FUTURE

PLANO ISD EDUCATION FOUNDATION ENDOWMENT CAMPAIGN



Plano Independent School District is a leader in fine arts education. The District recognizes that fine arts have intrinsic value in student development, and participation not only fosters interpersonal skills such as self-reliance, responsibility, problem-solving, and teamwork, but increases the likelihood that a student will graduate from school, attend college and meet commended status on standardized tests.

Acknowledging these benefits, Plano ISD implements a sequential fine arts curriculum that allows each student to build skill and understanding through a wide variety of artistic experiences. It all starts in elementary school, where students receive weekly visual arts and music instruction. In middle school, students can continue their artistic journeys in band, orchestra, choir, public speaking, debate, theatre, technical theatre, and 2D/3D art classes. By the time students reach high school, they can select from 84 distinct courses in art, dance, music, speech, and theatre.

Currently more than 80% of Plano ISD middle and high school students participate in fine arts programs, inspiring more than 18,000 total students each year.

This impressive level of dedication has led to other distinctions for the District including:



- ▣ Nationally recognized by National Association of Music Merchants Foundation as one of the best communities for music education.
- ▣ One of the highest percentages of all-state musicians in Texas.
- ▣ 3 of the Top 10 programs in Texas for AP art and music theory.

Despite these accolades and Plano ISD's commitment to fine arts, the District suffered from a lack of suitable performance space to accommodate these high-level programs and the volume of students who want to participate.

Among all 72 campuses in Plano ISD, only four have auditoriums appropriate for performances, and these have seating capacities of under 700. All high school, middle school, and elementary school campuses, except for one, have designated performance spaces connected with a gymnasium or auditorium. This not only limits the kinds of performances that can be mounted in these location, but it also limits the number of students and audience members that can participate or attend these performances. In addition, this absence of space forces campuses to rent out external venues for larger productions, combined performances or competitions, adding additional cost to the District's lean budget.

In 2016, the Plano ISD community approved \$64 million as part of the \$481 million bond for the design and construction of a multi-use, cross disciplinary performance and exhibition center. With the completion of this center, the District can provide spaces with size, capability, and quality needed to support all of Plano ISD's fine arts disciplines and talented students. It will also provide an attractive gathering space for the entire Plano community.

The Robbie & Lynore Robinson Fine Arts Center, named in memoriam Dr. George "Robbie" S. Robinson, Jr. and his wife Lynore, is set to open formally in the fall of 2021.

Designed by:

BORA
ARCHITECTURE & INTERIORS

**PERKINS
+ WILL**

In partnership with:

Theatrical Consultants
THEATRE PLANNERS / LIGHTING DESIGNERS
Schuler Shook

Acoustical Designers

JaffeHolden
Acoustics • Audio/Video • IT Infrastructure

Groundbreaking on the facility was April, 2018 by



Conveniently located at 1800 Alma Drive in Plano across from Academy High School, the Robbie & Lynore Fine Arts Center can accommodate the more than 325 performances, rehearsals, and events scheduled each year through Plano ISD's fine arts program.

Additionally, the Center will be available for public and corporate use, including trainings, conferences, receptions, and other events, making this facility a significant asset not only to Plano ISD, but the entire Plano community.

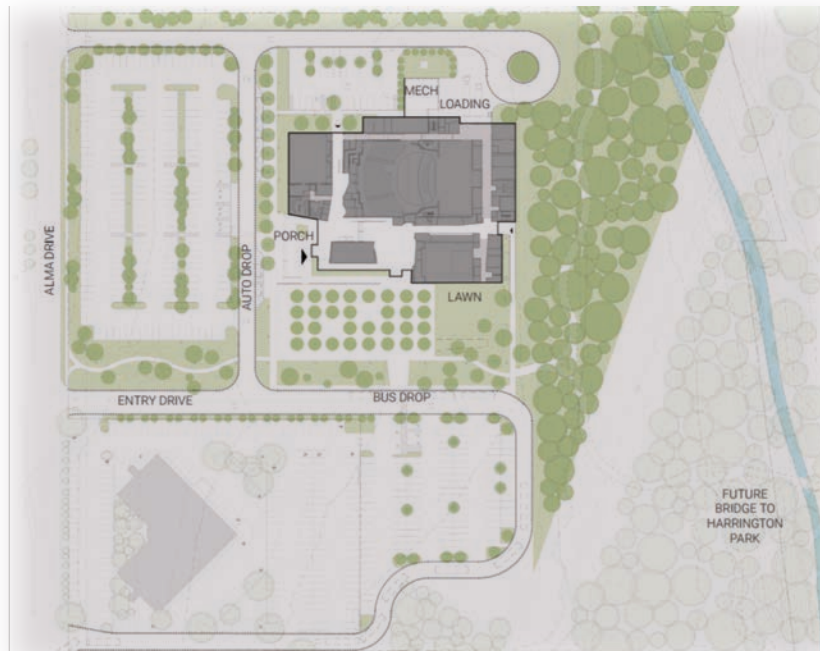

1800 Alma Drive | Plano, Texas 75075



While the citizens of Plano generously approved the bond that funded the design and construction of the Robbie & Lynore Robinson Fine Arts Center, *the annual programming and operating costs of the facility are estimated to be \$660,000 annually.* These costs include staffing and programming support, utilities, general operations, and maintenance - none of which eligible for the bond funding under Texas law.

For this reason, the Plano ISD Education Foundation has launched a \$3.2 million endowment campaign called *Staging the Future*, which will ensure the long-term financial stability of the Robbie & Lynore Fine Arts Center and establish it as an ever-present resource for Plano ISD students and the Plano community.

The Staging the Future endowment committee is chaired by Missy Bender, former Plano ISD Board of Trustees President and Director of Advocacy and Outreach for Raise Your Hand Texas Foundation who believes

“ Fine arts is a valuable element of the educational experience in Plano ISD. It provides a place for every student to learn creativity, diligence, patience, expression, teamwork, and a place to belong. It did it for me when I was a student in Plano ISD, and it did the same for my daughter. The Robbie and Lynore Robinson Fine Arts Center represents the high value that Plano ISD and the community place upon the artistic expression of Plano ISD students and its community members while serving as a space in which to explore new ideas and come together as neighbors.”

STAGING THE FUTURE

Together with the Plano ISD Education Foundation, Plano ISD, and Staging the Future Endowment committee, *YOU* can ensure the vitality of fine arts in Plano by becoming a Founding Patron.

Benefits of becoming a Founding Patron include the following:

- ▣ Naming opportunities for rooms and facility components, starting at \$2,500
- ▣ Invitations to special receptions and opening events
- ▣ Invitations to hard hat tours
- ▣ Recognition on the Founding Patrons wall in the main lobby
- ▣ Invitations to special screenings and performances
- ▣ Recognition on Plano ISD, Plano ISD Education Foundation, and Plano ISD Fine Arts websites, social media, annual reports, programs, media announcements, and more.

PLAYING YOUR PART

If you believe in the life-affirming experiences that fine arts provide in the lives of our students and community, please play your part through one of our naming opportunities or Founding Patron levels.

NAMING OPPORTUNITIES



STUDIO THEATER



REHEARSAL ROOM

Art Gallery	SOLD	\$500,000
Studio Theater		\$300,000
Dance Rehearsal Room		\$200,000
Outdoor Grove		\$150,000
Performance Lawn		\$150,000
Orchestra Pit		\$125,000

Art Studio		\$50,000
Main Lobby	SOLD	\$50,000
Upper Lobby		\$50,000
Scene Shop		\$50,000
Main Staircase		\$25,000
Lobby Overlook		\$25,000



[Redacted Name]

NAMING OPPORTUNITIES - continued

Legacy Gallery Promenade	\$25,000	Visiting Artist Dressing Room	\$15,000
Balcony Staircase	SOLD \$15,000	Dressing Room (4)	2 REMAINING \$10,000
Balcony Loft	SOLD \$15,000	Student Zone	\$5,000
Upright Pianos (2)	\$15,000	Benches (8)	4 REMAINING \$2,500
Green Room	\$15,000	Seats (Main Theater - 100)	\$500



FOUNDING PATRON LEVELS

Founders' Circle	\$100,000 and up	Curator	\$5,000 - \$9,999
Producer's Circle	\$50,000 - \$99,999	Playwright	\$1,000 - \$4,999
Maestro's Circle	\$25,000 - \$49,999	Choreographer	\$250 - \$999
Director	\$10,000 - \$24,999	Stage Crew	\$100 - \$249

Staging the Future Endowment Campaign Donors (as of 4.30.21)

George "Robbie" and Lynore Robinson Trust

Tammy Richards and Mike Douglass

Friends and Family of Kathy Kuddes

Bora Architecture and Interiors

Doug and Missy Bender

Plano Rotary Foundation

Glenn and Jean Callison

Marshall and Mabrie Jackson

Plano Council of PTAs

Randy McDowell

The Center that bears their name is an important cultural institution that will help to ignite the creative innovation of Plano ISD's students and provide a cultural hub for this community. I can think of no way to honor their legacy than by being a part of the endowment campaign to ensure the Robinson Arts Center serves as a home for the arts and a venue to bring people together well into the future.

- Gary Garcia, The Dallas Foundation

PLANO ISD EDUCATION FOUNDATION

BOARD OF DIRECTORS

OFFICERS

Tim McCoy, Board President, InTouch Credit Union

Jeff Beckley, Board President-Elect, Beckley & Associates, PLLC

Missy Bender, Treasurer, Raise Your Hand Texas

Leanne Libby, Secretary, Community Impact

Jennifer Jamieson, Immediate Past President, Community Volunteer

DIRECTORS

Lori Antonioli, Community Volunteer

Joshua Bourgeois, Children's Medical Center Plano

Chris Bragg, Banks of Ozarks

Earnest Burke, Plano Housing Authority

Jean Callison, Community Volunteer

Jeri Chambers, Community Volunteer

Harshal Chhaya, Texas Instruments

Stewart Clancy, Capital One

Tricia Clifton, CASA of Collin County

Lesley Guinn, Community Volunteer

Kenneth Hutchenrider, Jr., Methodist Richardson Medical Center

Lori Kirk-Rolley, Community Volunteer

Jennifer Lan, HaynesBoone

Jenna Maynard, Community Volunteer

Dr. Cameron Neal, Collin College

Auburn Pope, Community Volunteer

Candice Smith, Toyota Motor North America

Kelley Thomas, PISD Council of PTAs

Jamee Jolly, CAE, IOM, Senior Executive Director

ADVISORY DIRECTORS

Sara Bonser, Superintendent Plano ISD

Dr. Heather Wang, Representative, PISD Board of Trustees

Tarrah Lantz, Representative, PISD Council of PTAs

BOARD OF HONOR

Jim Boswell

Mitch Bramlett

Sharon Goldblatt

Rutledge Haggard

Rebecca Morris

Joan Slater

Beth Webb

John Wroten

Plano ISD Education Foundation Staging the Future Endowment Fund Manager

The Dallas Foundation



Plano ISD
**EDUCATION
FOUNDATION**

2700 W. 15th Street | Plano, TX 75075
469 752 8272 | www.nisd.edu/foundation

